



Tradition since 1895

For more than 120 years, OCULUS Optikgeräte GmbH has been a trusted partner for eye care professionals around the world. With the highest attention to detail, our devices are designed and manufactured at the OCULUS headquarters, located in Wetzlar, Germany. Thanks to our ten subsidiaries in Europe, Asia and America, and more than 200 distributors in over 80 countries, OCULUS is accessible to all customers around the globe.

More than 55% of OCULUS turnover is generated within the international market. There are about 380 employees working at the OCULUS headquarters – more than 60% of them in either research and development or production and service.

OCULUS is DIN EN ISO 13485 certified and applies high quality standards in development, production and service.

Visit www.ocus.de
to learn more about us
and our products



Follow us!



CONTENT

- 1 Workstation / Ophthalmic Tables
- 2 Anterior Segment Analysis / Tomography / Corneal Biomechanics
- 3 Myopia Management
- 4 Topography
- 5 Slit Lamp / Documentation
- 6 Vitreoretinal Surgery / SDI® / BIOM® Systems
- 7 Perimetry
- 8 Eye Test Units
- 9 Refraction
- 10 Orthoptic / Pleoptic / Stereo Tests / Loupes
- 11 OCULUS Contact / Index



The availability of products and features may vary by country, and OCULUS reserves the right to change product specifications and design. Please contact your local distributor for current product availability in your country.

Pico

The small performance miracle measuring a mere 1.35 m²

OCULUS Pico utilizes space efficiently while guaranteeing optimal ergonomic design. The basic unit consists of a slide-and-swivel table for two instruments and a drawer for storing a set of lenses. All Pico functions are controlled via an integrated membrane keypad. Pico can be equipped individually with refraction instruments such as a Keratograph or an Easygraph for fitting contact lenses, a slit lamp, an automatic or manual phoropter, etc. There are practically no limits to what you can combine. The completely integrated patient's seat can be fitted with armrests, a footrest and a headrest.

91250 **Pico workstation unit**, basic unit with slide-and-swivel table incl. drawer and patient's seat



Detailed brochure available



None of the devices shown are included in the basic unit, and some may be available in selected markets only. Please contact your local distributor for details.

Ophthalmic Tables



37420 Ophthalmic table for one device, symmetrical



37430 Ophthalmic table for one device, asymmetrical



37440 Ophthalmic table for one device, asymmetrical, wheelchair-accessible



37450 Ophthalmic table for two devices, delta-shaped tabletop



37460 Ophthalmic table for two devices, symmetrical

37475 Identical to 37460, but with
37485 different tabletop sizes



Detailed brochure available

All tables are equipped with two device connection cables located under the tabletop. Each table includes two network cables running through the column.

All feet are height-adjustable and the table base is optionally available on caster wheels.

Art. no.	Tabletop size	Lift	Weight	Max. load capacity	Electr. connection
37420	630 x 500 mm (24.8 x 19.7 in)	655 – 905 mm (26.4 – 34.3 in)	29 kg (63.9 lbs)	84 kg (185.2 lbs)	230 V
37430	770 x 500 mm (30.3 x 19.7 in)	655 – 905 mm (26.4 – 34.3 in)	33 kg (72.8 lbs)	84 kg (185.2 lbs)	230 V
37440	980 x 500 mm (38.6 x 19.7 in)	655 – 905 mm (24.5 – 34.3 in)	39 kg (86 lbs)	84 kg (185.2 lbs)	230 V
37450	1 050 x 570 mm (41.3 x 22.4 in)	655 – 905 mm (26.4 – 34.3 in)	36 kg (79.4 lbs)	84 kg (185.2 lbs)	230 V
37460	1 050 x 500 mm (41.3 x 19.7 in)	655 – 905 mm (26.4 – 34.3 in)	42 kg (92.6 lbs)	84 kg (185.2 lbs)	230 V
37475	770 x 500 mm (30.3 x 19.7 in)	655 – 905 mm (26.4 – 34.3 in)	33 kg (72.8 lbs)	84 kg (185.2 lbs)	230 V
37485	1 250 x 500 mm (49.2 x 19.7 in)	655 – 905 mm (26.4 – 34.3 in)	47 kg (103.6 lbs)	84 kg (185.2 lbs)	230 V

★ All tables are also available with 115 V.

Tabletop also available in custom colour design

The tabletop comes in discreet matte white. The edges are stained in dark brown. Custom colours on request. The table foot is powder-coated in light grey.



Pentacam®

Anterior segment tomography

The Pentacam® provides you with an overall view of the anterior eye segment in a matter of seconds. It delivers tomographic data on elevation, curvature and pachymetry of the entire cornea. Auto release accompanied by a quality test guarantee fast, reproducible and delegable measurements. The Pentacam® can be expanded individually to include optional software modules.

70700 Pentacam® incl. standard software



Detailed brochure available



Pentacam® HR

Anterior segment tomography with high-res Scheimpflug images

The high-resolution Pentacam® HR, equipped with a brighter, optimized lens system for brilliant image quality. The Pentacam® HR comes with a standard software package, which can be expanded as desired with optional software modules. Pentacam® HR images provide you with impressive depictions of IOLs and phakic IOLs. Alterations and injuries to the cornea as well as implants and refractive surgeries are revealed in spectacular manner.

70900 Pentacam® HR incl. standard software



Detailed brochure available



Pentacam® AXL

Anterior segment tomography and optical biometry

The Pentacam® AXL determines the axial length of the eye as well as the data of the anterior segment, from the anterior corneal surface to the posterior surface of the crystalline lens, all in a single measurement. It is an excellent diagnostic tool for screening routines, premium IOL selection and IOL power calculations as well as myopia control.

It also generates reliable data in difficult eyes. In addition to standard formulas for IOL calculation it offers special-purpose formulas such as for calculating toric IOLs or measuring pretreated corneas.

70100 Pentacam® AXL incl. standard software and various software packages



Detailed brochure available



NEW Pentacam® AXL Wave

Scheimpflug tomography, axial length, total wavefront, refraction, retroillumination

The new Pentacam® AXL Wave is a high-class device for optimal pre- and post-op diagnostics for refractive and cataract surgeons. It includes all advantages of the Pentacam® AXL as well as ocular wavefront, objective refraction and retroillumination for checking IOL centration and axis position post-operatively.

70020 Pentacam® AXL Wave incl. standard software and various software packages



Detailed brochure available



Corvis® ST

Evaluation of corneal biomechanical response, tonometry and pachymetry

The revolutionary Corvis® ST records the reaction of the cornea to a defined air pulse using a newly developed high-speed Scheimpflug camera. This camera captures over 4300 images per second, permitting highly precise measurement of IOP as well as corneal thickness and biomechanical response.

Based on a video of 140 images, taken within 31 ms after onset of the air pulse, the Corvis® ST provides a detailed assessment of corneal biomechanical properties. The information obtained on the biomechanical response of the cornea is used to calculate a biomechanically corrected IOP (bIOP). Furthermore, ectatic diseases such as keratoconus or post LASIK ectasia can be detected at a very early stage. Biomechanical changes after crosslinking are measured and visualized with an advanced biomechanical comparison software. Biomechanical properties also play an important role in the development and progression of glaucoma. Screening for normal-tension glaucoma is therefore possible with the Corvis® ST.



72100 Corvis® ST



Detailed brochure available

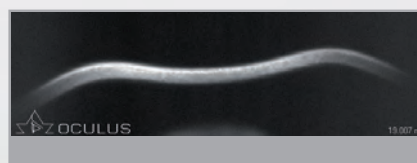

A high-speed Scheimpflug camera takes more than 4300 images per second

Combining Tomography with Biomechanical Properties gives you the complete view

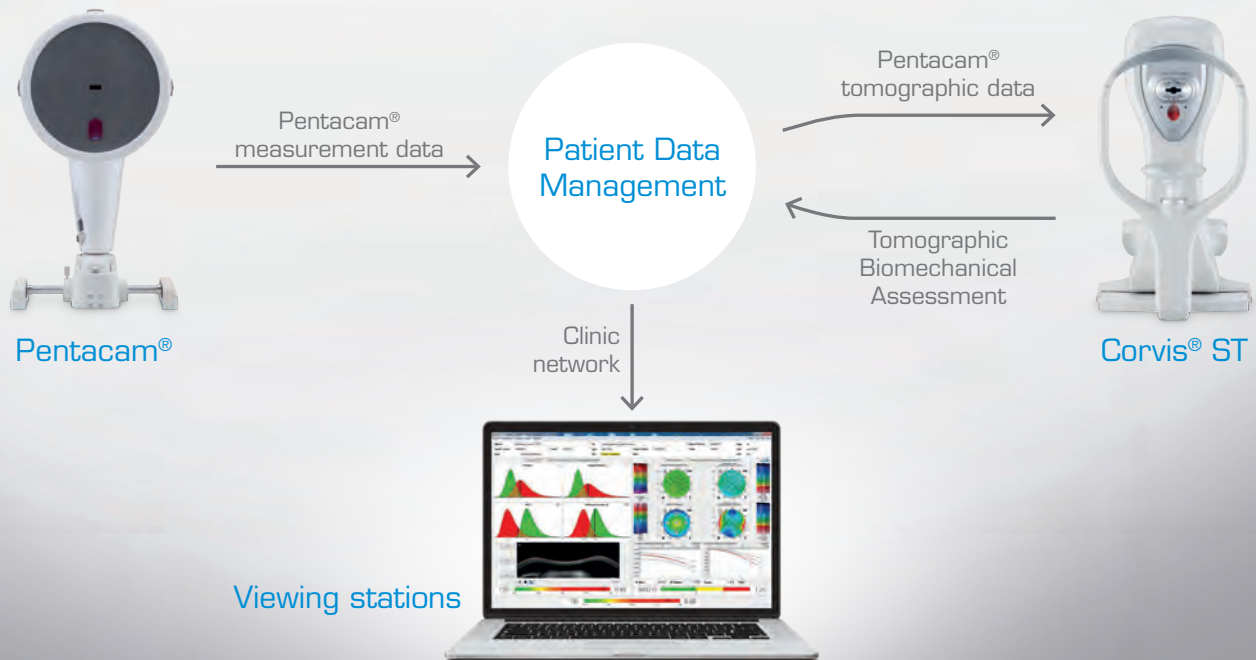

PARK 1®

Non-contact pachymeter, autorefractor and keratometer

The PARK 1® is a precise autorefractor and keratometer with a compact, space-saving design devised for assessing the objective refraction and the central radii of the cornea. With its integrated patient data management system, examination and patient data can be stored on one and the same instrument. Optional non-contact pachymetry on the basis of a Scheimpflug image allows for precise, contact-free measurement of corneal thickness.

The PARK 1® is equipped with a data interface for direct transfer of refraction results to a phoropter. Alternatively, a data interface is available which can be connected to customary practice and optician software.

64900 PARK 1® with pachymetry function



Detailed brochure available



Myopia Management

Short-sightedness in children and adolescents on the rise

The well-known Brien Holden Vision Institute has forecast that by the year 2050 one out of two individuals could be affected by myopia. Those affected have a greater risk of developing severe eye disease such as cataract or retinal detachment and eventual blindness.

This outlook makes it more than clear that early detection and management of myopia are becoming more and more important.

Early detection of risk factors is essential for counteracting the increase in myopia in children and adolescents.

Myopia prevalence around the world

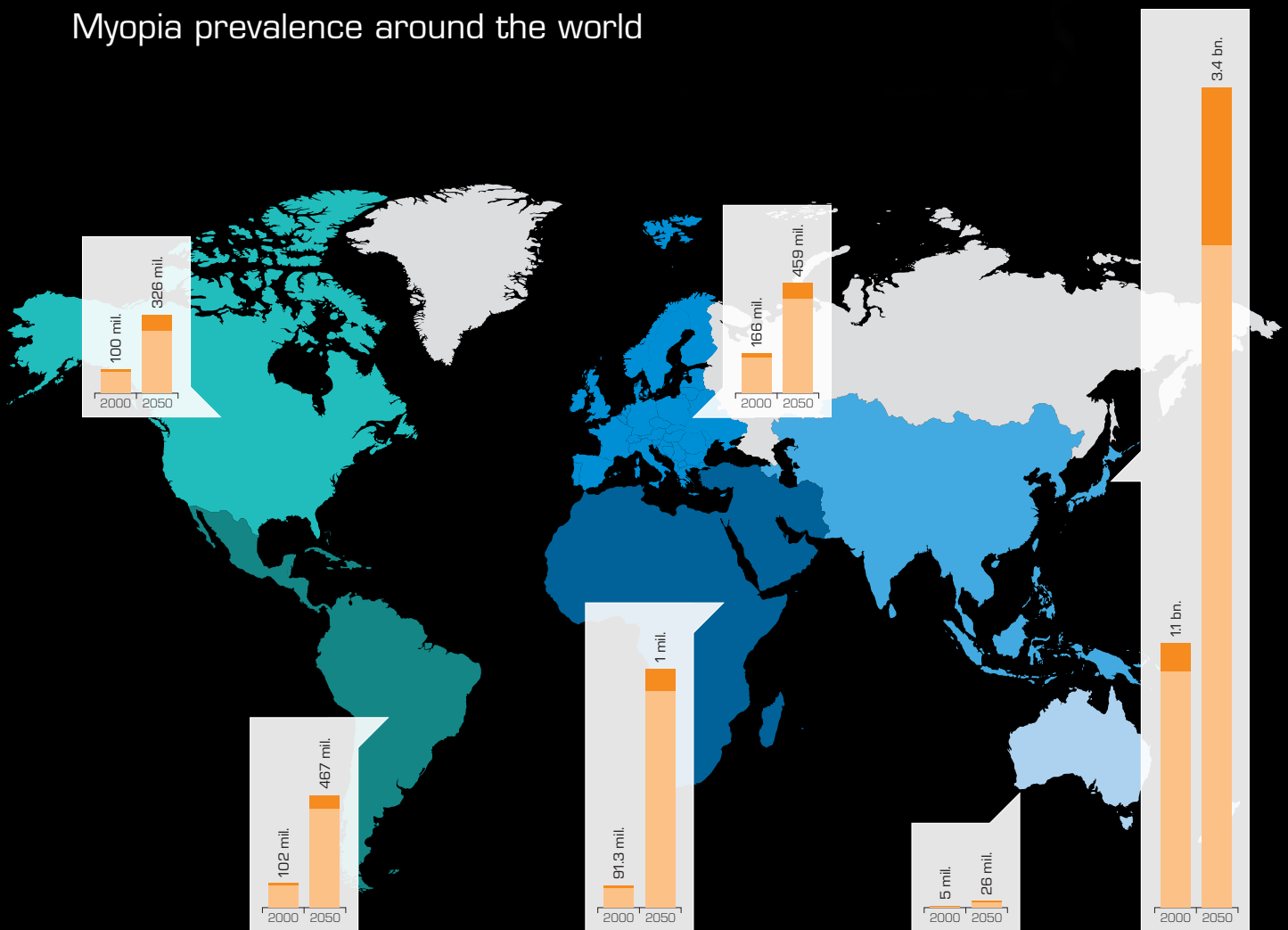

Source: *Ophthalmology*, 2016 May;123(5):1036-42. doi: 10.1016/j.ophtha.2016.01.006. Epub 2016 Feb 11. Global Prevalence of Myopia and High Myopia and Temporal Trends from 2000 through 2050. Holden BA et al.

myopes (-0.5 D until -5.0 D) high myopes (>5.0 D)

NEW Myopia Master[®]*

Refraction, axial length and keratometry

The new Myopia Master[®] is the first device that combines the most important parameters, making myopia detection and management much easier and more reliable than ever:

Refraction

A commonly used method for measuring myopia is by refraction. However, day-to-day measurement variability and the need to be able to perform refractions in children with induced cycloplegia require additional parameters for a professional myopia management.

Axial length

This can be measured accurately and independently of accommodation. Progression in axial length is a reliable indicator of progression in myopia.

Keratometry

The central corneal radii, as a refractive component of the eye, can be automatically measured and clearly displayed.

68100 Myopia Master[®]

*Available in Germany as of 2020

www.myopia-master.com



Keratograph 5M

Topographer and dry eye screening device

The Keratograph 5M has become an integral part of the ophthalmological and optometric practice. Examiner-independent measurements provide reliable data, clear analyses and full documentation. The Keratograph 5M is a popular device for dry eye screening because of its enhanced tear film related examination possibilities.

The Keratograph 5M contains features that offer optimal conditions for your image documentation such as the high-resolution colour camera and different illumination options.

White ring illumination is used to measure thousands of points on the entire corneal surface. Infrared ring illumination is also available for analyzing the tear film in order to prevent reflex tear secretion caused by glare.

The Keratograph software includes a reliable screening package for corneal disease detection, lens fitting and refractive surgery.

77000 **Keratograph 5M** for attachment to a workstation unit or ophthalmic table



Detailed brochure available





Keratograph 4

Topographer and keratometer

Gold standard corneal topography – ensures reliability when it comes to taking measurements, providing consultation and fitting contact lenses. The integrated keratometer and automatic measurement activation guarantee perfect reproducibility.

All important parameters of the cornea can be analyzed with the standard software. Numerous optional examination and evaluation functions are available.

70670 **Keratograph 4** for attachment to a workstation unit or ophthalmic table



Detailed brochure available

Easygraph

Compact topographer and keratometer

The Easygraph uses the same precise measuring technology as the Keratograph and is both a topographer and a keratometer combined into one unit. Numerous analysis and display formats support eye specialists in their quantitative classification of the cornea. The Easygraph can be easily attached to most conventional slit lamps with minimum additional space requirements.

70620 **Easygraph**



Detailed brochure available



SL-IC5 and SL-IC4

Universal slit lamps with pioneering features

Sharp optics combined with bright, homogeneous slit illumination guarantees you a clear view with the OCULUS SL-IC4 and SL-IC5.

Stereomicroscope with converging binoculars and smooth-switching five-step magnification changer from 6x through 40x (6x, 10x, 16x, 25x, 40x). Integrated in the microscope is also a yellow filter which can simply be interposed when needed. Both models have decoupling function as a standard feature.

Take advantage of the wide range of filters (blue, red free, neutral density, diffuser) integrated in the new OCULUS slit lamp to improve the quality of your examination results. Its no-hassle controls allow you to focus entirely on the examination.

Carefully selected LED modules guarantee you the very best lighting conditions as well as durability.

Both slit lamp models are available in a "digital ready" version.

65802	SL-IC5 Slit lamp
65822	SL-IC5 D Slit lamp, "digital ready"
65842	SL-IC4 Slit Lamp
65862	SL-IC4 D Slit lamp, "digital ready"



Detailed brochure available

*OCULUS SL-IC4 D
with a compact design*



*OCULUS SL-IC5 D
with a slim, tall design*





Detailed brochure
available

ImageCam® 3

Slit lamp documentation

The OCULUS ImageCam® 3 is one of the smallest slit lamp documentation systems on the market and can be adapted to almost all commercially available slit lamps. Slit lamp images are taken by a high-resolution digital USB 3.0 camera triggered by a foot switch (SL-IC5, SL-IC4). Entire slit lamp examinations can be recorded as video sequences from which the most conclusive images are taken and saved for purposes of findings documentation. Exposure time, light magnification and white balance can be easily adjusted with the user-friendly software.

The ImageCam® 3 includes a beam splitter with a mechanical iris aperture for adjusting the depth of focus. Its swivel in/out function allows for full binocular viewing when the camera is not needed.

69200 - 69330 **ImageCam® 3**

“Digital ready” – easy to upgrade to a photo slit lamp!

Both slit lamp models are available in a “digital ready” version. The OCULUS SL-IC4 D and SL-IC5 D both come with a digital port for connection to the OCULUS image documentation system ImageCam® 3. Images and videos can be conveniently captured by joystick rather than with the foot switch.



Table

With either model, if the OCULUS slit lamp is not to be mounted on an existing workstation unit or there is no space for the OCULUS Ophthalmic Table, it can be delivered mounted on a suitable table complete with head and chin rests vertically adjustable on a lifting column and caster wheels.

Applanation tonometers

Various matching applanation tonometers for numerous popular slit lamps of most manufacturers.



BIOM® 5

Perfect viewing for non-contact wide-angle observation

The easy handling of the BIOM® 5 persuades more and more surgeons. While observing the vitreous and the fundus, the BIOM® 5 is aligned coaxially with the operating microscope. During extraocular phases of surgery, it is swung aside out of the observation beam while the inverting action of the SDI® is neutralized manually, by foot switch or automatically, if the SDI® 4c/ BIOM® 5c are used. All sterilizable parts of the BIOM® system are steam autoclavable following the latest recommendations.

A steam autoclavable micro switch for control of the SDI® 4c guarantees convenience at its best. The activation of the inverter function is ensured as long as the position of the BIOM® 5c requires it. Of course the SDI® can be controlled independently. Including the improvements of the BIOM® 5m, the latest version, the BIOM® 5c offers additionally the convenience of motorized focusing of the BIOM® image.

It incorporates the intelligent and automatic control of the corresponding inverter, the SDI® 4c.

55400	BIOM® 5c
55403	BIOM® 5cl
55462	BIOM® 5m
55463	BIOM® 5ml



Detailed brochure available



SDI®

Stereoscopic Diagonal Inverter

The convenience of automatic inversion provided by the SDI® 4c ensures the surgeon's view is always orientated properly. This is accomplished through a fully autoclavable micro switch on the BIOM® 5c versions. During extraocular phases of surgery it is swung out of the observation beam while the inverting action of the SDI® is neutralized: Automatically, by a surgeon controlled footswitch or manually.

54300 SDI® 4e (electronic inversion)

54320 SDI® 4c (automatic inversion)

54302 SDI® 4m (manual inversion)



Detailed brochure
available



BIOM® Connecting Spacer

If your microscope already incorporates a stereoscopic diagonal inverter, you don't have to miss out on the benefits of the OCULUS BIOM® 5c and BIOM® 5cl. Ask the OCULUS team about the BIOM® Connecting Spacer.

54841 BIOM® Connecting Spacer

BIOM® Optic Set

Lens for single-use

The OCULUS BIOM® HD Disposable Lens combines an extremely wide field of view with high definition clarity. This makes it ideal for all stages of vitreoretinal surgery including macula viewing under high magnification.

The innovative single-use design ensures a perfect view in every case. Single-use design stands for increased O.R. efficiency and lower costs.

The BIOM® Optic Set is compatible with all OCULUS BIOM® 3/4/5.

54411 BIOM® Optic Set HD Professional for f = 175 mm

54412 BIOM® Optic Set HD Professional for f = 200 mm

54415 BIOM® Optic Set HD Flex



Detailed brochure
available



Also available for
the ZEISS RESIGHT®:
HD Disposable LenZ

BIOM® ready

The world's first single-use wide-angle viewing system

From the inventors of non-contact wide-angle viewing, comes the world's first single-use wide-angle viewing system: The BIOM® ready provides the retinal surgeon the same unparalleled view they have come to rely on with the BIOM® system.

The single-use BIOM® presents the perfect balance between flexibility and high optical quality. Furthermore surgeons benefit from the lack of "down time" for increased O.R. efficiency.

54413 BIOM® ready for f = 175 mm

54414 BIOM® ready for f = 200 mm



Detailed brochure available



130° wide-angle field of view with outstanding resolution



New reduction lens is designed to optimize the view of the retina and the limbus, increasing surgical efficiency

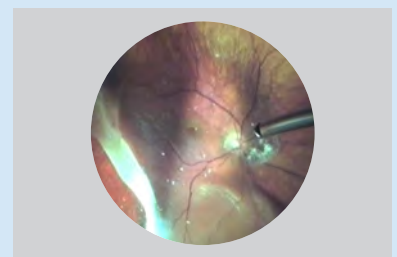

HD clarity under high magnification



BIOM® ready sterile blister pack



Connects easily to your microscope



Ready for use

Super View HTC Lens

Hassan-Tornambe Contact Lens, disposable

The familiar clarity and image quality of the Tornambe Contact Lens now with an improved stability mechanism developed by Dr. Tarek Hassan. It has an absorbent customizable ring with four legs to maximize stability, providing the surgeon with superior control and visualization.

54012 **Super View HTC Lens**



Detailed brochure available



Super View Pivot

For single-use on the OCULUS BIOM® systems

Two in one: The Super View Pivot incorporates two lenses, 130° and 90°, for both wide-field and mid-peripheral viewing. The 180° turning radius allows for smooth switching between the two lenses, no need to re-focus.

54014 **Super View Pivot for f = 200 mm**

54015 **Super View Pivot for f = 175 mm**



Detailed brochure available



Easyfield® C

Full-fledged compact automated perimeter for visual field tests up to 30° eccentricity

The OCULUS Easyfield® C is a full-fledged compact perimeter capable of performing standard automated perimetry of the central visual field up to 30° eccentricity. It has been designed for the combined use as visual field screener and perimeter, offering features usually available only in large units. The spherical bowl with 30 cm (11.81 in) radius is enclosed into an ergonomically movable cone equipped with a distance adapted lens. The Easyfield® conforms to the Goldmann standard and fulfills the ISO 12866 norm for perimeters.

Measurements of the Easyfield® are carried out using an LED grid with 135 fixed test locations, including the common 30-2, 24-2 and 10-2 patterns. The novel SPARK test strategy leads to faster and more stable threshold tests providing improved diagnostic capabilities. Besides the standard field indices the Easyfield® delivers evaluations of the innovative Glaucoma Staging Program (GSP) and the classifications provided by the enhanced Glaucoma Staging System (GSS 2).

15000 **Easyfield® C** automated perimeter with adjustable chin rest



Detailed brochure available





Smartfield

LCD perimeter for visual field tests up to 60° eccentricity

The Smartfield is optimized for monitoring functional impairment in glaucoma, using the SPARK examination strategy for testing glaucoma patients. This device can also extend visual field measurements into the periphery.

14000 **Smartfield**



Detailed brochure available



Centerfield® 2

Projection perimeter for visual field tests up to 70° eccentricity

The closed design of the Centerfield® 2 and the shaded view into the perimetric bowl allow for visual field examinations in normally lit rooms. This practical table-top device with reduced footprint can be deployed in almost any setting.

56980 **Centerfield® 2** projection perimeter



Detailed brochure available

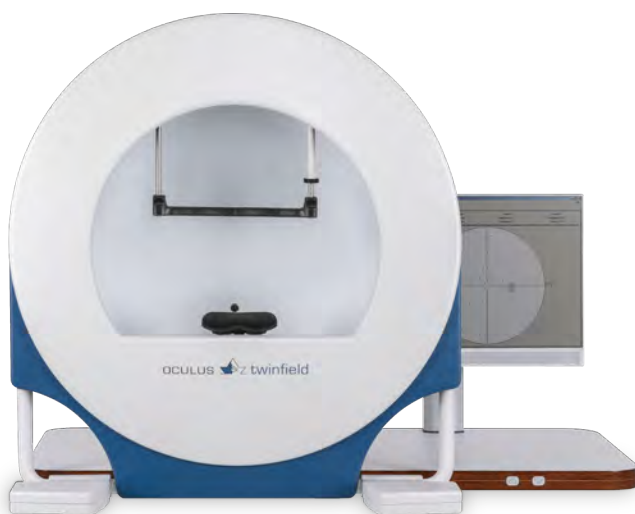

Twinfield® 2

Full-field projection perimeter for static and kinetic visual field tests

The ergonomic design of the Twinfield® 2 ensures increased patient comfort, while its reduced test duration, intuitive operation and powerful analysis tools help provide the examiner with conclusive diagnostic information.

56920 **Twinfield® 2** projection perimeter



Detailed brochure available

Binoptometer® 4P

Professional vision testing device

The Binoptometer® 4P is a professional screening instrument for testing all relevant visual functions. The used future-oriented technology allows an almost unlimited representation of various vision tests. The vision tests are presented on a high-resolution micro-color display, allowing a virtually unlimited presentation of vision tests. The Binoptometer® 4P enables to test contrast sensitivity, optional mesopic vision and glare sensitivity with just one instrument.

The Binoptometer® 4P can be adapted to many different requirements, due to the adjustable examination distance continuously from 30 cm (11.81 in) to infinity.

Convenient height adjustment range of 10.5 cm (4.13 in). In addition, the viewing angle is fully adjustable up to a 35° downgaze, thus enabling testing to be done ergonomically with any eyeglasses.

Fulfills all current standards
(DIN EN ISO 8596, DIN 58220 Part 5, 6 and 7)

59860 **Binoptometer® 4P** with height adjustment

59862 **Binoptometer® 4P**



*Detailed brochure
available*





Mesotest® II / Mesotest® II konkav

Program-controlled examination of mesopic vision and glare sensitivity

Tests of mesopic vision and glare sensitivity are important supplements to photopic vision testing, especially when night driving capacity must be assessed. If the patient has IOL implants or has undergone refractive surgery, it is advisable to check mesopic vision and glare sensitivity both pre- and postoperatively as well as before prescribing tinted lenses.

62800 **Mesotest® II**

62801 **Mesotest® II konkav**, same as Mesotest® II, with integrated concave lenses (-0.5 D / -1.0 D / -1.5 D) for detecting night myopia



*Detailed brochure
available*

C-Quant

Straylight measuring instrument for quantifying light scattering

Straylight is measured objectively directly on the retina. Increased straylight in the eye reduces the quality of visual impressions. The OCULUS C-Quant is based on the scientific research of Dr. T. J. T. P. van den Berg from the Royal Netherlands Academy of Arts and Sciences.

Examination results are quantified age-dependently, depicted in diagrams and stored automatically, the C-Quant is activated by a computer.

80000 **C-Quant** incl. software and 12 corrective lenses in wooden case



*Detailed brochure
available*





HMC-Anomaloskop

Heidelberger Multi-Color-Anomaloskop for professional assessment of color vision

The Heidelberg Multi-Color-Anomaloskop is a microprocessor-controlled device for assessment of red-green and blue-green color vision and precision diagnosis of its deficiencies. There are two versions available, both equipped with integrated automatic neutral adaptation: **The HMC-Anomaloskop (R)** for precision diagnosis of red-green color vision deficiencies (Rayleigh equation). **The HMC-Anomaloskop (MR)** for precision diagnosis of both red-green (Rayleigh equation) and blue-green (Moreland equation) color vision deficiencies.

47700 HMC-Anomaloskop (MR)

47720 HMC-Anomaloskop (R)



Detailed brochure available

H-Test

Nonverbal visual acuity test

The H-Test is a child-friendly nonverbal visual acuity test including a matching box (display unit) and melody feedback for a testing distance of 3 m. This visual acuity test is easy to perform, as it engages children in a playful way. The H-Test is suited for children between 3 and 6 years of age as well as for less articulate children. It provides a way of identifying children at risk of amblyopia at an early stage with little time expenditure and simple equipment.

47300 H-Test acc. to Hohmann/Haase, with infrared remote control



Vissard 3D

Vision testing device for day and night

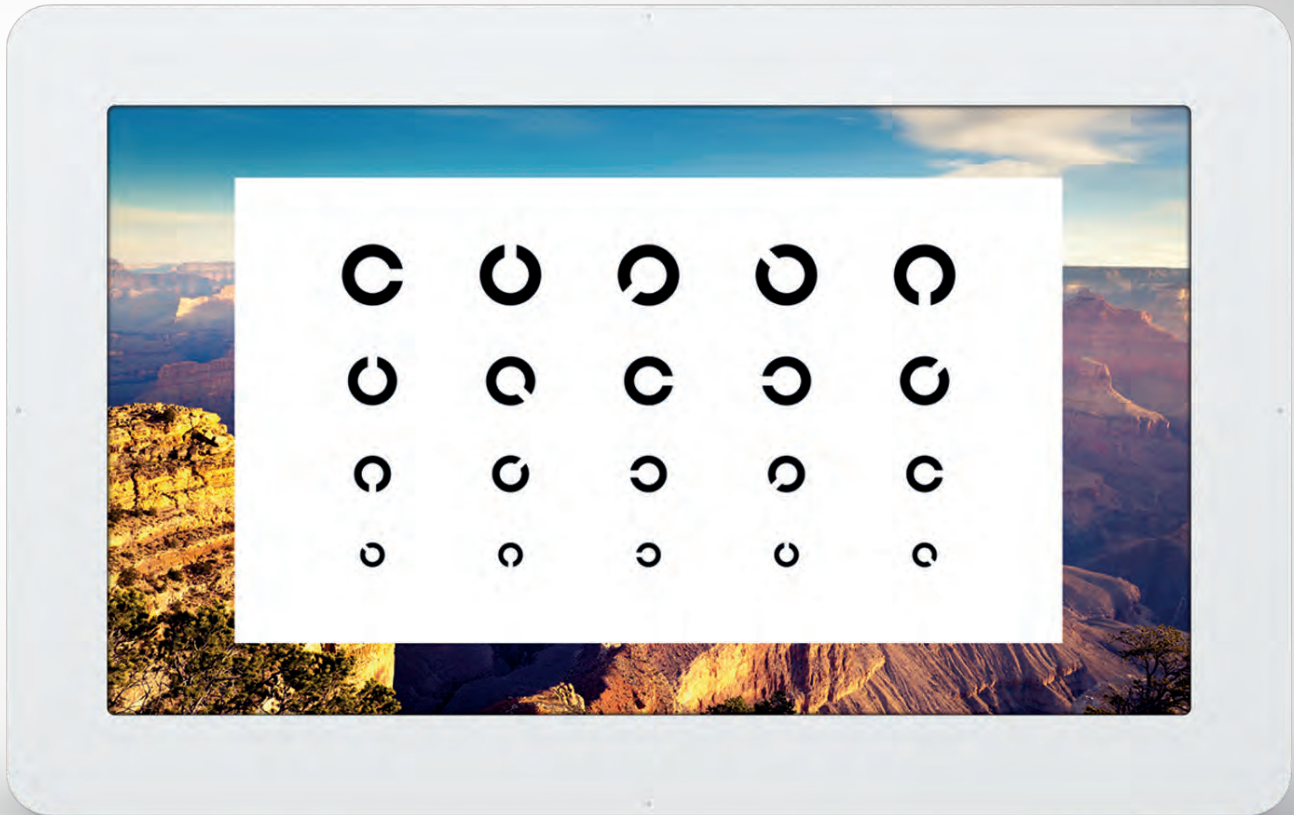

Detailed brochure
available



The **Vissard 3D** is a solidly professional, expert refraction device, which increases your customers' acceptance and let them have fun with various reality vision tests such as number plate or chalk board reading.

16030 Vissard 3D



The **Vissard MOBIL** was developed for modern eyecare professionals who want to be able to also work with precision outside the examination room. It is a compact, fully fledged refraction system of the Vissard family which stands out for its portability and versatility in use.

16020 Vissard MOBIL

Eye Charts

Visual acuity tests

V = visual acuity values at 5 m testing distance (the visual acuity values for 6 m testing distance are also given on the charts except for on chart 46936, where they are only given for 5 m), plastic coated.

Visual acuity data in decimals

Dimensions: approx. 290 x 490 mm (W x H)

46016	Eye chart Letter	V = 0.125 – 1.0
46036	Eye chart Pictures for children	V = 0.125 – 1.0
46066	Eye chart Numerals	V = 0.125 – 1.0
46116	Eye chart Letters	V = 0.1 – 1.25
46166	Eye chart Numerals	V = 0.1 – 1.25
46346	Eye chart Numerals, Letters	V = 0.125 – 1.66
46926	Eye chart E-hook	V = 0.1 – 1.0
46936	Eye chart Pictures for children acc. to Löhlein	V = 0.2 – 1.0

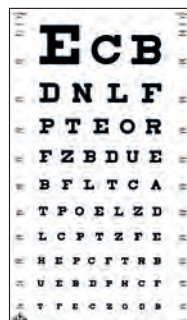

46016



46036

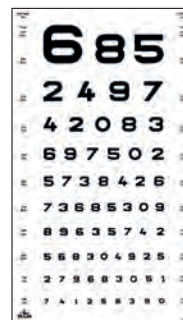

46066

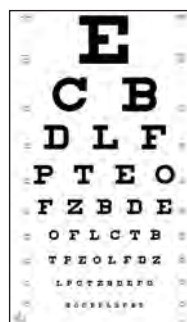

46116

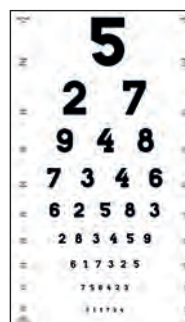

46166

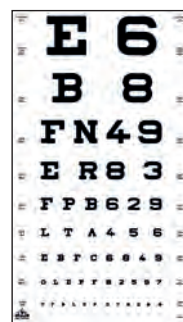

46346

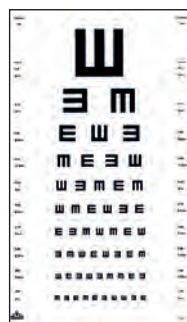

46926



46936

Set of Eye Charts

Visual acuity tests

Visual acuity < 0.2 (DIN 58220), plastic coated, testing distance 1 m, Landolt rings in 8 positions (left, right, top, bottom and in the four diagonal positions).

Visual acuity data in decimals

Chart 1: visual acuity = 0.02 – 0.025

Chart 2: visual acuity = 0.032 – 0.2

Dimensions: approx. 360 x 455 mm (W x H)

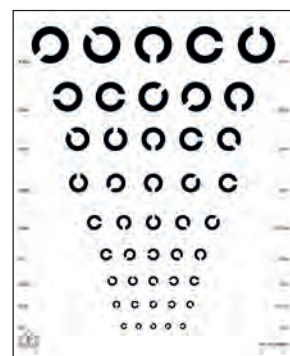
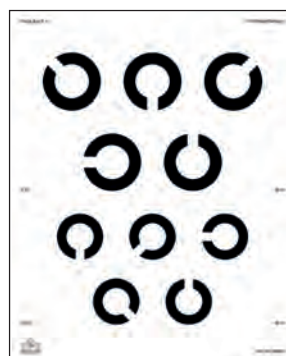

46940 Set

46940	Set of eye charts (consists of two charts) for expert advisory visual acuity testing
-------	---



45600

Illuminated Eye Test Cabinet

Visual acuity test

The illuminated eye test cabinet is designed for OCULUS eye charts measuring 290 x 490 mm. The illuminated cabinet is equipped with two shielded LED lamps and comes with a pull-cord switch and a power supply cable. Dimensions: approx. 410 x 105 x 560 mm (W x D x H) Weight: approx. 2.5 kg

45600 Illuminated eye test cabinet
incl. one eye chart (46016 – 46936) of your choice
(only 230 V)

45651 LED lamp, 230 V, 4.5 W for 45600

MARS Letter Contrast Sensitivity Test

Visual contrast sensitivity test

The MARS letter contrast sensitivity test is a set of three eye charts presenting very large letters with low visual acuity demands in a progression of weakening contrast, providing a quick and simple means of testing a person's visual contrast sensitivity.

Dimensions: approx. 230 x 5 x 360 mm (W x D x H)

Testing distance: 40 cm

47280 MARS Letter Contrast Sensitivity Test
3 eye charts with 48 large-sized letters per chart, incl. a robust storage folder and a user manual with a copyable results sheet



C-Test for Near and Distance Vision

Visual acuity test acc. to Haase/Hohmann

Test for determining visual acuity as well as any crowding phenomenon, developed for children from the age of 7, adolescents and adults.

C-Test for near vision examination, consisting of 6 charts with logarithmically graduated visual acuity values (40 cm reading distance). This eye exam is distinguished by the fact that the distances (2 different distances) between the characters remain constant for all visual acuity levels and the smallest distances are comparable to those of real texts. Line-wise, the Landolt ring is arranged in random sequence with the gap oriented in different directions. The size of the Landolt ring decreases from line to line with the demand on visual acuity increasing.

47020 **C-Test for near vision** by Haase/Hohmann (A5), 6 charts with Landolt rings, 20 visual acuity levels, one 50-sheet pad of evaluation forms, wooden pointers

47021 **Evaluation form for near-vision C-Test**, 5 pads of 50 sheets

C-Test for distance vision examination, consisting of 3 individual charts (rows 2.6' optotype spacing, rows 17.2' optotype spacing, single optotypes). Charts for distance visual acuity test apply the same parameters as those used for near visual acuity test; $V = 0.16 - 1.25$. Testing distance: 5 m

46966 **Distance visual acuity test (C-Test)**



47020: Only available in German

Aniseikonia Test

The Awaya aniseikonia test in book format for near vision is based on red-green separation. The test comprises 24 test images showing red and green semi-circles.

47220 **S. Awaya new aniseikonia tests**, booklet, incl. red-green goggles

42700 **Red-green goggles**



Colour Eye Tests

Ishihara Colour Chart

Testing colour perception

Ishihara colour charts are ideal for the screening of hereditary red-green colour vision defects. Available in four different versions, book format.

Testing distance: 75 cm

47640 **Ishihara's tests for colour deficiency, 38 plates edition**

47600 Ishihara's tests for colour deficiency, 24 plates edition

47610 Ishihara's tests for colour deficiency, 14 plates edition

47620 Ishihara's design charts for colour deficiency of unlettered persons, 10 plates

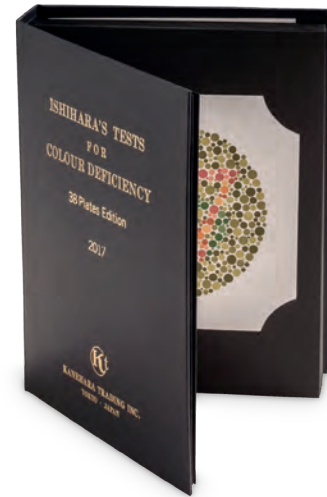

Matsubara Colour Charts

Colour vision test plates for the infants

Matsubara colour charts are ideal for the screening of hereditary red-green colour vision defects. 10 test plates in book format, suitable from pre-school age up.

Testing distance: 75 cm

47625 **Matsubara colour test plates for the infants,** book format, 10 plates, incl. 6 matching charts



Colour Arrangement Tests

Quick screening test for differentiation between mild and pronounced colour vision defects.

47650 **Farnsworth colour test panel 15 D (saturated),** in wooden box, incl. evaluation form

47651 **Lanthony colour 15 HUE (desaturated),** in wooden box, incl. evaluation form



Universal Trial Frame UB 6

For refraction professionals

In the new product development of the UB 6 we put ergonomics, simple handling and optimal wearing comfort front and center.

The UB 6 is made of the finest materials. Many ideas and suggestions for improvements from our customers have been integrated in the new development: for example, the nose piece and its adjustment options have a fully

new construction. Also new is the lens holder, with four slots in front and two behind. Optional polarizing filters with large viewing area for distance and near vision: linear and circular available.

42600 Universal Trial Frame UB 6



Detailed brochure available

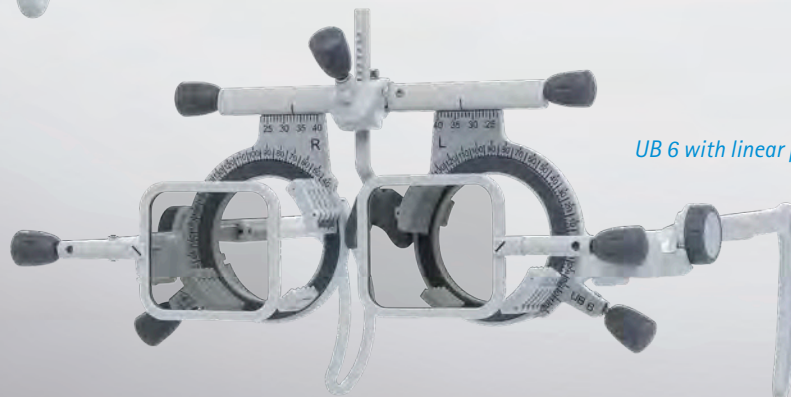
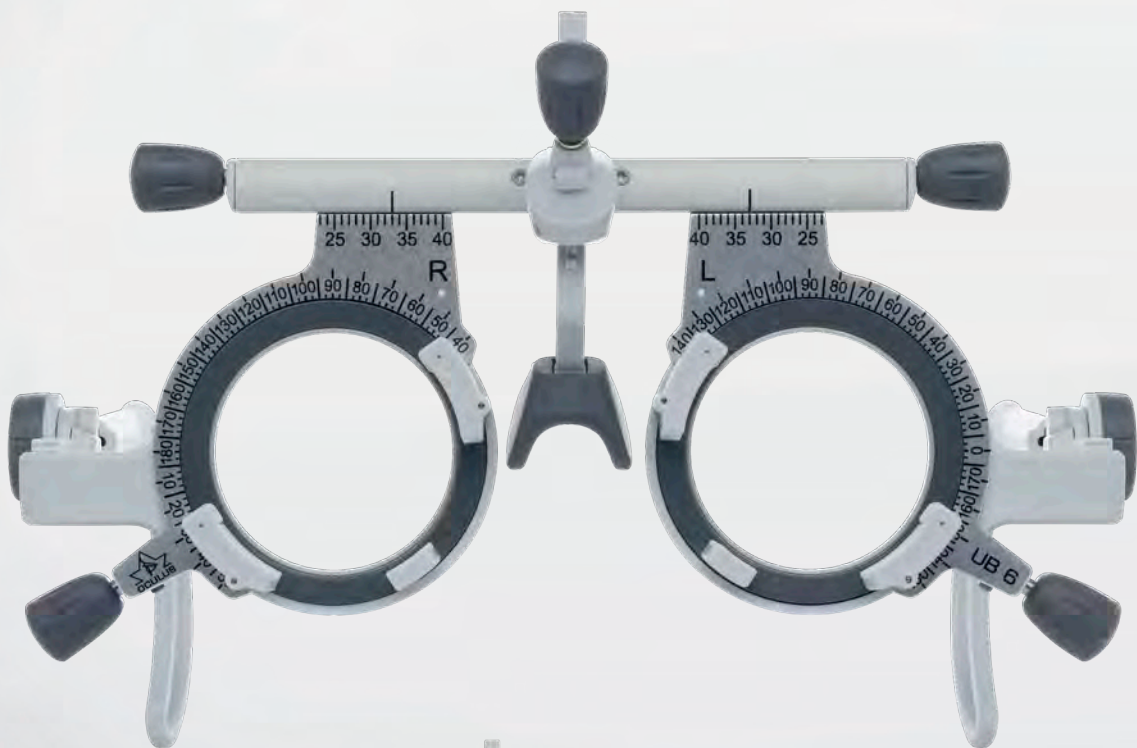

UB 6 with linear polarizing filters

Universal Trial Frame UB 4

The reliable universal trial frame

Our high-end model UB 4 offers ergonomically optimized user elements for cylinder axis, PD, nose bridge and bow adjustment. Optional polarizing filters with large viewing area for distance and near vision: linear and circular available.

42500 Universal Trial Frame UB 4



Detailed brochure
available

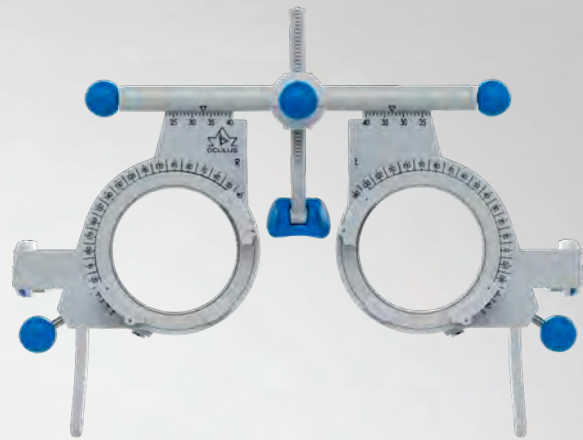

UB 4 with circular
polarizing filters



Universal Trial Frame UB 4 höhenverstellbar*

A vernier scale for more precision

In addition to optimized user elements and light weight, which are standard features among OCULUS trial frames, the UB 4 höhenverstellbar has something more to offer: even finer precision. Its single height-adjustable glassholders allow each side to be adjusted individually, i.e. independently of the other eye, and not only horizontally but also vertically. This is complemented by a vernier scale, permitting measurements to a precision of a quarter millimetre.

42503 Universal Trial Frame UB 4 höhenverstellbar*,
incl. beechwood case



Detailed brochure
available

*höhenverstellbar ['hø:ənʃtɛg'ʃtɛlba:r] = height-adjustable

Universal Trial Frame UB 3+

Tried and tested –
and now rejuvenated

The optimized UB 3+ is carefully crafted by hand with the highest attention to detail. A slip-on rotary polarizing filter (linear) by Hegener is available.

42100 **Universal Trial Frame UB 3+**



Detailed brochure
available



UB 3+ with linear
polarizing filter



42580

Half-eye Trial Frame

Approved half-eye trial frames for adults with three slots for each side, PD adjustable from 59 to 67. Also available with adjustable nose bridge.

42580 **Half-eye Trial Frame**, rigid nose bridge

42588 **Half-eye Trial Frame**, adjustable nose bridge



Detailed brochure
available

Half-eye Trial Frame for Children

These half-eye trial frames for children have been especially designed for small heads, PD adjustable from 54 to 58. Also available with adjustable nose bridge.

42480 **Half-eye Trial Frame**, rigid nose bridge

42488 **Half-eye Trial Frame**, adjustable nose bridge



Detailed brochure
available



42488

Trial Lens Cases BK Line

Unsurpassed quality made by OCULUS

Comparison between tl (trial lens, bottom) for Universal Trial Frames UB 3+/UB 4/UB 4 höhenverstellbar*/UB 6, half-eye trial frames and tls (trial lens small, top) for Universal Trial Frame UB 5.

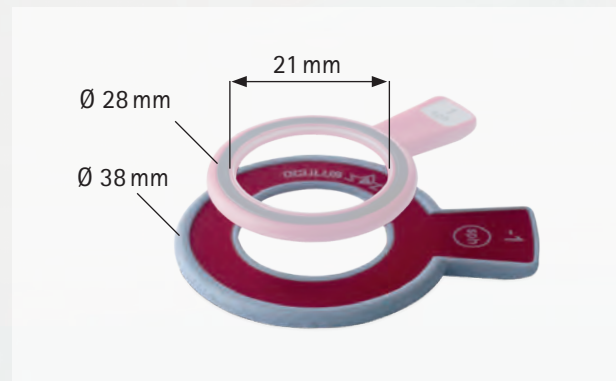
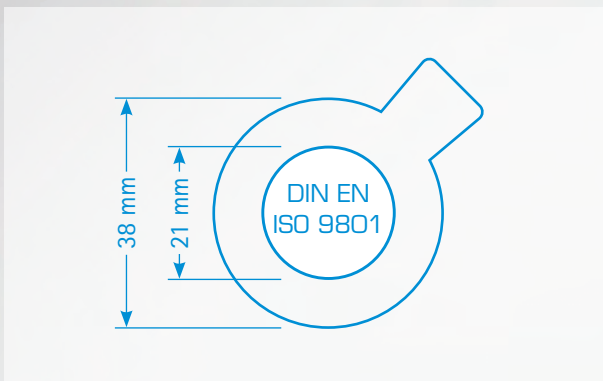

BK 1

Comprehensive trial lens case

Large-set trial lens case containing 228 trial lenses. Available as table and wall version in grey white with roll top.

33180 Trial Lens Case BK 1/T, table version

33280 Trial Lens Case BK 1/W, wall version



Detailed brochure available



*höhenverstellbar ['hø:ənfæg'fɛlba:r] = height-adjustable

BK 1 SE

Optimized trial lens case

Large-set trial lens case containing 240 coated trial lenses. Available as table and wall version in dark grey with roll top.

331871 Trial Lens Case BK 1 SE/T, coated, table version

332861 Trial Lens Case BK 1 SE/W, coated, wall version



Detailed brochure
available



BK X/O

Trial lens case with maximal features

All-in trial lens case (acc. to Kochniss) in table version containing 422 coated trial lenses. The two-level layout stands out for highest comfort in use. Available as table version in grey white with roll top.

33101 Trial Lens Case BK X/O, coated, table version



Detailed brochure
available





BK 2

Compact trial lens case

Practical wooden trial lens case containing 130 trial lenses. Ideal for mobile use.

33480 Trial Lens Case BK 2, beechwood case



*Detailed brochure
available*

Prism Lens Case

Compact trial lens case

Practical wooden trial lens case containing 72 coated prismatic trial lenses.

33106 Prism Lens Case, coated, beechwood case



*Detailed brochure
available*



BK F

Trial lens case for fine adjustment

Practical add-on case containing 12 coated trial lenses for spherical and cylindrical fine adjustment.

33120 Trial Lens Case BK F, coated, beechwood case



*Detailed brochure
available*



Trial Lens Cases BK S Line

Small trial lenses for small heads

The only way to further reduce the PD in universal trial frames is to reduce trial lens rims. That's exactly what OCULUS does: Same size lenses with thinner rims permit PD adjustment down to 40 mm – ideal for small heads and children.

Comparison between t1s (trial lens small, top) for Universal Trial Frame UB 5 and t1 (trial lens, bottom) for Universal Trial Frames UB 3+ / UB 4 / UB 4 höhenverstellbar* / UB 6 and the half-eye trial frames.

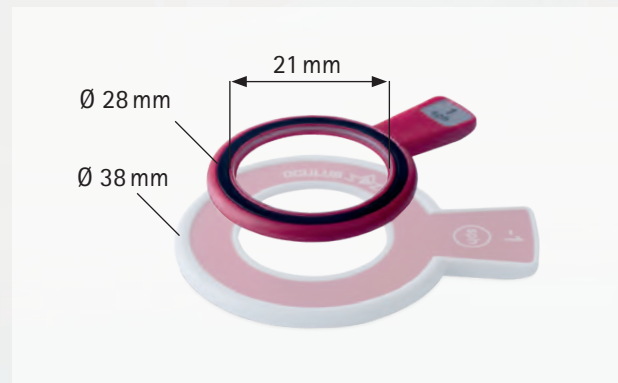
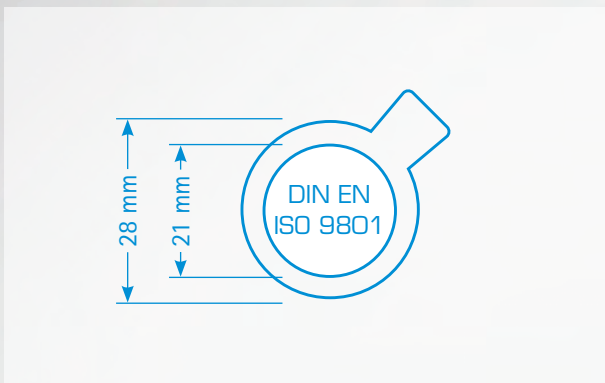

Universal Trial Frame UB 5

For small heads and children

This trial frame has been especially designed for small heads. It is distinguished by its low weight, large contact areas and hence optimal weight distribution. The PD is adjustable from 40 to 72 mm. The UB 5 accommodates up to 10 trial lenses with an outer diameter of 28 mm (t1s = trial lens small).

42550 Universal Trial Frame UB 5



Detailed brochure available

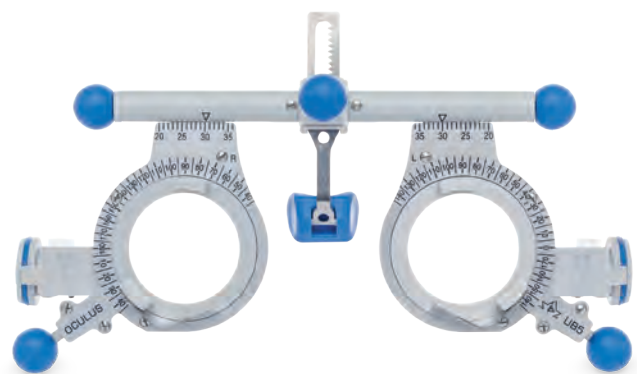

UB 5 with linear polarizing filters



*höhenverstellbar ['hø:ənʃtɛlba:r] = height-adjustable

BK S1

Comprehensive trial lens case

Large-set trial lens case containing 228 trial lenses. Available as table and wall version in grey white with roll top.

33190 Trial Lens Case BK S1/T, table version

33197 Trial Lens Case BK S1/W, wall version



Detailed brochure available

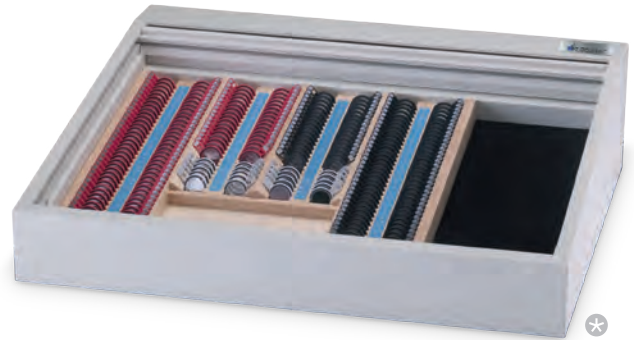

33190

BK S2

Compact trial lens case

Practical wooden trial lens case containing 130 trial lenses. The practical case provides space for additional accessories such as the UB 5.

33490 Trial Lens Case BK S2, beechwood case



Detailed brochure available



* The trial lenses in the BK S line have a rim diameter of 28 mm (lens diameter 21 mm). Suitable for Universal Trial Frame UB 5 only.

BK S3

Comprehensive trial lens case

Practical wooden trial lens case containing 192 trial lenses. Ideal for mobile use.

33501 Trial Lens Case BK S3, beechwood case



Detailed brochure available



Prism Lens Case S

Compact prism lens case

Practical wooden trial lens case containing 72 coated prismatic trial lenses.

33116 Prism Lens Case S, coated, small beechwood case



Detailed brochure available



* The trial lenses in the BK S line have a rim diameter of 28 mm (lens diameter 21 mm). Suitable for Universal Trial Frame UB 5 only.

Spherical Balance Lenses

- 36610 Spherical balance lens sph ± 0.12 D, with handle, coated
 36620 Spherical balance lens sph ± 0.25 D, with handle, coated
 36640 Spherical balance lens sph ± 0.50 D, with handle, coated



36620

Vario Cross Cylinder

- 36730 Vario-cross cylinders (by Reiner), with effect changes ± 0.25 D and ± 0.50 D, coated



36730

Jackson Cross Cylinder

- 36710 Jackson cross cylinder ± 0.12 D, with handle, coated
 36720 Jackson cross cylinder ± 0.25 D, with handle, coated
 36740 Jackson cross cylinder ± 0.50 D, with handle, coated
 36780 Jackson cross cylinder ± 1.00 D, with handle, coated



36740

Retinoscopy Mirror

- 49700 Retinoscopy mirror, 45 mm diameter



49700

Retinoscopy Bars

- 48110 Retinoscopy bars with slider (by Trousseau),
 2 pcs. incl. transparent plastic case

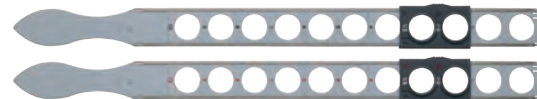

48110

Refraction Bars

- 36600 Refraction bar, sph ± 0.25 and ± 0.50 D
 36605 Refraction bar, sph ± 0.25 and ± 0.50 D, coated



36600

Polaroid Hand Held Frame

- 45830 Polaroid hand held frame, linear (45°/135°)



45830

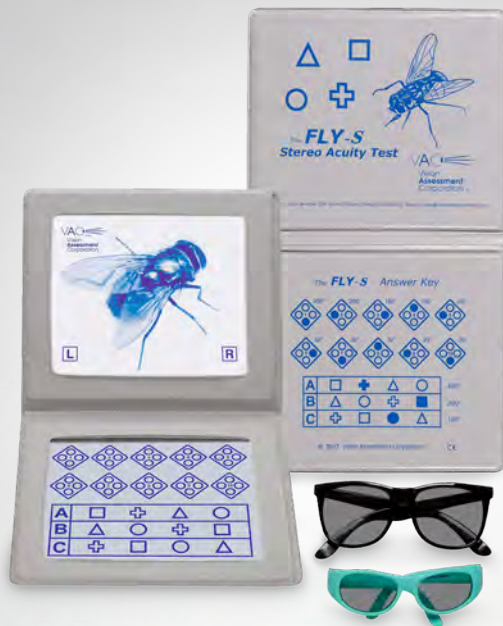

50945



50920



50700
50702

Stereo Tests

Screening test for adults and children

Simple tests for early detection of impairment of spatial vision among children, infants of pre-verbal age and adults.

- 50935 **Random Dot 1S stereo test with geometric shapes**, book format, incl. 2 pairs of polarizing goggles (adults, children)
- 50945 **Fly-S stereo test with geometric shapes**, book format, incl. 2 pairs of polarizing goggles (adults, children)
- 50955 **Butterfly-S stereo test with geometric shapes**, book format, incl. 2 sheets of polarizing film (adults, children)
- 50941 **Polarizing goggles for adults**
- 50942 **Polarizing goggles for children**
- 50920 **TNO test for stereoscopic vision**, nineteenth edition book format, incl. TNO red-green goggles
- 50921 **Pair of red-green goggles for TNO Stereo Test** (right eye: green, left eye: red)
- 50922 **TNO stereo test, ring book**, without red-green goggles
- 50700 **LANG Stereotest I®**, test chart in plastic cover
- 50702 **LANG Stereotest II®**, test chart in plastic cover
- 50703 **LANG Fixation Cube**, white
- 50704 **LANG Fixation Stick**

Maddox Cross

Tangent scale

A Maddox cross is a tangent scale for squint angle measurement and retinal correspondence testing. It consists of two plastic scales, one large-digit for 5 m testing distance and one small-digit for 1 m testing distance. In the centre of the scale is a spot fixation LED light which should be located at eye level exactly in front of the patient during the examination.

Dimensions: approx. 1 290 x 28 x 1 290 mm (W x D x H)

43705 **Maddox cross**, incl. LED illumination and adapter



Detailed brochure available



Prism Bars and Prisms

- 44010 **Prism bars, set** (horizontal and vertical, incl. two single prisms) in case:
horizontal 1, 2, 4, 6, 8, 10, 12, 14, 16, 18, 20, 25, 30, 35, 40 PD
and single prism 45 PD
vertical 1, 2, 3, 4, 5, 6, 8, 10, 12, 14, 16, 18, 20, 25 PD
and single prism 30 PD
- 44011 **Prism bar, horizontal** 1 to 40 PD, single prism 45 PD, in case
- 44012 **Prism bar, vertical** 1 to 25 PD, single prism 30 PD, in case
- 44020 **Single prism**, rounded form, plastic, set of 22 single prisms and 1 red lens, in case
- 44022 **Single prism**, cornered form, plastic, set of 22 single prisms and 1 red lens, in case

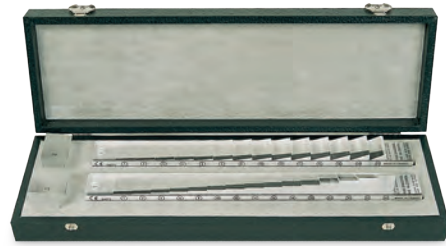

44010



44022

Demonstrators

- 46970 **Demonstrator** with Landolt ring
- 46980 **Demonstrator** with E-hook



46970



46980

Occluders

- 43980 **Occluder**, approx. 78 x 49 mm (W x H)
- 43990 **Occluders**, small, set of 3, approx. 42 x 36 mm (W x H)
- 35890 **Occluder** with handle and clip (Cover-/Uncover-Test)
- 35100 **Occluder** with Additional Features



43980



43990



35890



35100



Lorgnettes

- 42770 **Lorgnette with striated lenses** (Bagolini), axes 45° and 135°
- 42771 **Lorgnette with striated lenses** (Bagolini), axes 90° and 180°
- 36870 **Dark-red lens** with handle and clip
- 42700 **Red-green goggles**
- 42710 **Red-green lorgnette**



42700



42710



42770



36870

Easyloupe® Titan

Magnifying loupe

The Easyloupe® Titan is a binocular loupe which provides larger magnification than conventional aids do and is intended for uses where these are no longer sufficient. This makes it the ideal binocular loupe for both professional and leisure use. The Easyloupe® Titan is a titanium-made featherweight fitted with proven OCULUS optics.

39730 Easyloupe® Titan 1.8x/370¹⁾
incl. solid case

39735 Easyloupe® Titan 2.5x/400¹⁾
incl. solid case

¹⁾ Magnification/working distance in mm



Detailed brochure
available



39735



Binocular Loupes

Magnifying vision aids

OCULUS binocular loupes are combined vision aids consisting of a pair of metal-frame spectacles and a magnifying unit. They stand out for their absolute marginal sharpness and high wearing comfort. Each model is a real lightweight, guaranteeing an ergonomic fit and sustained wearing comfort even after long hours of use. The high field of depth and excellent image quality additionally protect the examiner's eyes against fatigue. Corrective or protective lenses (lens width 54 mm, bridge width 18 mm) can be fitted into the metal frame as desired.



39750	Binocular Loupe 1.8x/370¹⁾
39751	Binocular Loupe 1.8x/370 ¹⁾ with near portion adapter
39756	Magnifying unit 1.8x/370 ¹⁾ without spectacle frame
39757	Magnifying unit 1.8x/370 ¹⁾ with near portion adapter, without spectacle frame
39770	Binocular Loupe 2.5x/400¹⁾
39771	Binocular Loupe 2.5x/400 ¹⁾ with near portion adapter
39776	Magnifying unit 2.5x/400 ¹⁾ without spectacle frame
39777	Magnifying unit 2.5x/400 ¹⁾ with near portion adapter, without spectacle frame
39786	Magnifying unit 2.5x/300 ¹⁾ without spectacle frame
39787	Magnifying unit 2.5x/300 ¹⁾ with near portion adapter, without spectacle frame
39620	Magnifying unit 1.8x/370 ¹⁾ , with bandeau
39625	Magnifying unit 2.5x/400 ¹⁾ , with bandeau
39780	Binocular Loupe 2.5x/300¹⁾
39781	Binocular Loupe 2.5x/300 ¹⁾ with near portion adapter



¹⁾ Magnification/working distance in mm

Accessories

39670	Slip-on lens 2.5x mountable on 1.8x (2 pcs.)
39680	Slip-on lens 2.0x mountable on 1.8x (2 pcs.)
39790	Case for loupe

Mirror Exophthalmometer

Eyeball protrusion

The exophthalmometer is used for measuring and quantifying eyeball protrusion (exophthalmus) in mm.

52400 **Mirror Exophthalmometer acc. to Hertel**

52401 **Mirror Exophthalmometer acc. to Naugle, with infra- and supraorbital rest, incl. wooden box**



52400



52401

Nystagmus Spectacles

The examiner can closely observe how the patient's brightly illuminated eyes move under the spectacles' magnifying lenses during forward gaze and diagnose any nystagmus.

42901 **Nystagmus spectacles acc. to Frenzel, battery version, type 503 (without batteries)**

42902 **Nystagmus spectacles acc. to Frenzel, battery version, type 703 (without batteries)**

42903 **Nystagmus spectacles acc. to Frenzel, 4 V alternating voltage, type 501**

42904 **Nystagmus spectacles acc. to Frenzel, LED, battery version, type 803 (without batteries)**

51210 **Transformer for nystagmus spectacles type 501, 3 - 6 V, adjustable 1A, 210 - 230 V**



42902

Pinhole Goggles

An extremely light-weight, easy-to-fit pair of goggles with slots for corrective lenses.

42820 **Pinhole goggles acc. to Lindner**



42820

OCULUS Worldwide



 **OCULUS Headquarters**
 OCULUS Optikgeräte GmbH
 Münchholzhäuser Str. 29 • 35582 Wetzlar • GERMANY
 Tel. +49 641 2005-0 • Fax +49 641 2005-295
 Email: export@oculus.de • www.oculus.de

 **OCULUS Asia Ltd. Hong Kong**
 Unit C-E, 18/F, Billion Plaza 2, 10 Cheung Yue Street
 Cheung Sha Wan, Kowloo • HONG KONG
 Email: info@oculus.hk • www.oculus.asia

 **OCULUS Brasil**
 Rua Emília Marengo, 687 – 2º Andar – VI. Regente Feijó
 03336-000 São Paulo – SP • BRASIL
 Tel. +55 11 2533 2533 • Fax +55 11 3892 1129
 Email: info@oculus.com.br • www.oculus.de/br/

 **OCULUS Canada**
 Tel. +1 425 670 9977 • Fax +1 425 670 0742
 Email: sales@oculus.ca • www.oculus.ca

 **OCULUS Czechia**
 OCULUS, spol. s r.o.
 Pardubická 765 • 500 04 Hradec Králové • CZECH REPUBLIC
 Tel. +420 495 531 140 • Fax +420 495 531 145
 Email: oculus@oculus.cz • www.oculus.cz

 **OCULUS Iberia S.L.**
 Sector Escultores nº 4 Local 5
 28760 Tres Cantos • Madrid • SPAIN
 Tel. +34 91 804 00 07
 Email: info@oculus.es • www.oculus.es

 **OCULUS Poland**
 OCULUS Spółka z o.o.
 ul. Potocka 4/12 • 01-652 Warszawa • POLAND
 Tel./Fax +48 22 833 3208
 Email: biuro@oculus.pl • www.oculus.pl

 **OCULUS Slovakia**
 OCULUS - Co.spol.s r.o.
 Hontianska 1 • 82109 Bratislava • SLOVAKIA
 Tel./Fax +421 2 5341 1067
 Email: office@oculus.sk • www.oculus.sk

 **OCULUS USA**
 OCULUS, Inc.
 17721 59th Avenue NE
 Arlington • WA 98223 • USA
 Tel. +1 425 670 9977 • Fax +1 425 670 0742
 Email: sales@oculususa.com • www.oculususa.com

OCULUS Surgical, Inc.
 562 Mercantile Place Ste. 102
 Port St. Lucie • FL 34986 • USA
 Tel. +1 772 236 2622 • Fax +1 772 336 1984
 Email: info@oculussurgical.com • www.oculussurgical.com

 **OCULUS Turkey A.S.**
 Ugur Mumcu'nun Sokağı • N° 49/206660 Ankara • TURKEY
 Tel. +90 312 405 6002
 Email: info@oculus-turkey.com.tr • www.oculus-turkey.com.tr

Index

A	
Aniseikonia Test	28
Anomaloskop	24
Autorefractor	9 / 11
Axial length	7 / 11
B	
Bagolini	41
Binocular Loupes	43
Binoptometer® 4P	22
Biomechanics	8 / 9
BIOM® 5	16
BIOM® Connecting Spacer	17
BIOM® Optic Set	17
BIOM® ready	18
BK 1	33
BK 1 SE	34
BK 2	35
BK F	35
BK S1	37
BK S2	37
BK S3	38
BK X/O	34
C	
Centerfield® 2	21
Corneal Biomechanics	8 / 9
Colour Arrangement Tests	29
Colour Eye Tests	29
Contact	45
Contact Lens	19
Corvis® ST	8
C-Quant	23
C-Test for Near and Distance Vision	28
D	
Demonstrators	41
E / F / G	
Easyfield® C	20
Easygraph	13
Easyloupe® Titan	42
Eye Charts	26
Eye Test Cabinet	27
Eye Test Units	22 - 29
H / I	
Half-eye Trial Frame	32
Half-eye Trial Frame for Children	32
Hassan-Tornambe Contact Lens	19
HD Disposable LenZ (for ZEISS RESIGHT®)	17
HMC-Anomaloskop	24
H-Test	24
Illuminated Eye Test Cabinet	27
ImageCam® 3	15

H / I	
Ishihara Colour Chart	29
J	
Jackson Cross Cylinder	39
K	
Keratograph 4	13
Keratograph 5M	12
Keratometer	9 / 11 / 13
L	
Lorgnettes	41
Loupes	42
M	
Maddox Cross	40
Magnifying vision aids	43
MARS Letter Contrast Sensitivity Test	27
Matsubara Colour Charts	29
Mesotest® II / Mesotest® II konkav	23
Mirror Exophthalmometer	44
Myopia Management	10 / 11
Myopia Master®	11
N	
Nystagmus Spectacles	44
O	
Occluders	41
Ophthalmic Tables	5
Optical biometry (biometer)	7
Orthoptic	41
P / Q	
Pachymetry	8 / 9
PARK 1®	9
Pentacam®	6
Pentacam® AXL	7
Pentacam® AXL Wave	7
Pentacam® HR	6
Perimetry	20 / 21
Pico	4
Pinhole Goggles	44
Pleoptic	41
Polaroid Hand Held Frame	39
Prism Bars and Prisms	41
Prism Lens Case	35
Prism Lens Case S	38
R	
Red-green goggles	41
Red-green lorgnette	41
Refraction Bars	39
Retinoscopy Bars	39
Retinoscopy Mirror	39
Retroillumination	7

S	
Scheimpflug images	6/7
SDI®	17
Set of Eye Charts	26
SL-IC4	14
SL-IC5	14
Slit lamps	14
Smartfield	21
Spherical Balance Lenses	39
Stereo Tests	40
Straylight measurement	23
Subsidiaries	45
Super View HTC Lens	19
Super View Pivot	19
T	
Tangent scale	40
Tomography	6/7
Tonometry	8
Topography	12/13
Trial Frames	30-32/36
Trial Lens Cases BK Line	33
Trial Lens Cases BK S Line	36
Twinfield® 2	21
U	
Universal Trial Frame UB 3+	32
Universal Trial Frame UB 4	31
Universal Trial Frame UB 4 höhenverstellbar	31
Universal Trial Frame UB 5	36
Universal Trial Frame UB 6	30
V/W/X/Y/Z	
Vario Cross Cylinder	39
Vissard 3D	25
Vissard Mobil	25
Vitreoretinal Surgery	16-19
Workstation	4



WWW.OCULUS.DE



OCULUS is certified by TÜV according to
DIN EN ISO 13485 MDSAP

OCULUS Optikgeräte GmbH

Postfach • 35549 Wetzlar • GERMANY

Tel. +49 641 2005-0 • Fax +49 641 2005-295

Email: export@oculus.de • www.oculus.de

Find your local OCULUS representative on our website.

OC/1895/WZ/EN
GK/003/EN

The availability of products and features may vary by country. OCULUS reserves the right to change product specifications and design. All information is valid at the time of printing (08/19).